

USER MANUAL

ICE MAKER
Model CZB-15

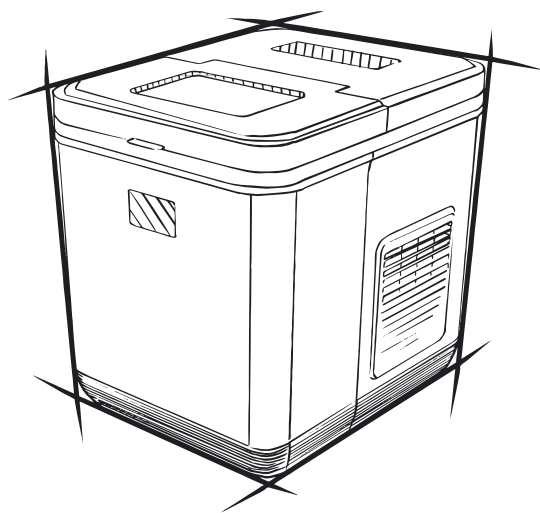

Palby Marine R/S, Korsvej 3, 6000 Kolding, Denmark, CVR nr. 13619883 - palby@palby.dk



Please read this operating manual carefully before starting the device.
Keep it in a safe place for future reference.

CONTENTS

SAFETY INSTRUCTION	Page1
PRODUCT FEATURES	Page3
PRODUCT STRUCTURE	Page3
FUNCTION AND OPERATION	Page4
CLEANING AND MAINTENANCE	Page5
TROUBLESHOOTING	Page6
WARRANTY	Page7
TECHNICAL INFORMATION	Page7

1.SAFETY INSTRUCTIONS

WARNING!

- Do not operate the appliance if it is visibly damaged.
- Do not block the gaps of the fridge with things like pin, wire, etc.
- Do not expose the appliance to rain or soak it in water.
- Do not place the appliance near naked flames or other heat sources (heaters, direct sunlight, gas ovens etc.)
- Do not store any explosive substances like spray cans with a flammable propellant.
- Ensure the supply cord is dry and not trapped or damaged. Do not locate multiple portable socket-outlets or portable power supplies at the rear of the appliance.
- Check the voltage specification on the type plate corresponds to that of the energy supply. The appliance is only to be used with the power supply unit provided with the appliance.
- Do not use electrical appliances inside the food storage compartments of the appliance, unless they are of the type recommended by the manufacturer.
- Once unpacked and before turning on, the appliance must be placed on a level surface for more than 2 hours.
- Make sure that the appliance stays horizontally when it is running. The tilt angle must be less than 10°.
- Keep the ventilation openings in the unit casing or in the built-in structure free of obstacles within 150mm.
- Keep the appliance stable on the ground or in the car; Do not drain upside down.
-   : Risk of fire/ flammable materials.

CAUTION!

- Repairs may only be carried out by qualified personnel. Incorrect repair may cause danger. The lamp and supply cord must be replaced by the manufacturer or qualified persons.
- The installation of DC power in the boat must be handled by qualified electricians.
- Children shall not play with the appliance. Cleaning and user maintenance shall not be made by children without supervision.
- The appliance can be used by children aged from 8 years and above and persons with reduced physical, sensory or mental capabilities or lack of experience and knowledge if they've been given supervision or instruction concerning use of the device in a safe way and understand the hazards.

NOTICE!

- Disconnect the power supply before each cleaning and maintenance and after every use.
- Do not use sharp tools to defrost; Do not damage the refrigerant circuit.
- If the appliance is left empty for long periods, switch off, defrost, clean, dry, and leave the door open to prevent mould developing within the appliance.

- Fill with potable water only.
- Appliance are suitable for camping use.
- To avoid contamination of Ice, please respect the following instructions:
 - Opening the door for long periods can cause a significant increase of the temperature in the compartments of the appliance.
 - Clean regularly surfaces that can come in contact with linner and accessible drainage systems.
- The appliance is intended to be used in household and similar applications such as:
 - Staff kitchen areas in shops, offices and other working environments;
 - Camping, Farm houses and by clients in hotels, motels and other residential environments;
 - Bed and breakfast type environments;
 - Catering and similar non-retail applications.
- If the compressor stops operating due to reasons such as water shortage, full ice bin, power outage, etc., the compressor will have a 3-minute delay before restarting the ice-making process (Please avoid frequent on/off cycles).

 Please according to local regulations regarding disposal of the appliance for its flammable refrigerant and blowing gas.

2.PRODUCT FEATURES

- High-efficiency DC compressor and conversion module.
- DC12V/24V or AC 100~240V, 50/60Hz (using dedicated adapter) power supply.
- Intelligent car battery protection system:
 - 1) DC12V: cut out(10.1V), cut in(11.4V); 2) DC24V: cut out(22.3V), cut in(23.7V).
- Equipped with the temperature sensing system, automatically adjusts the ice-making time per cycle based on the ambient temperature. Making 9 ice cubes in 8.5 minutes (based on 25°C/77° F ambient temperature).
- Daily Capacity: 24 lbs per day.
- Details: transparent cover, ice scoop, removable ice basket, drain plug.

3.PRODUCT STRUCTURE

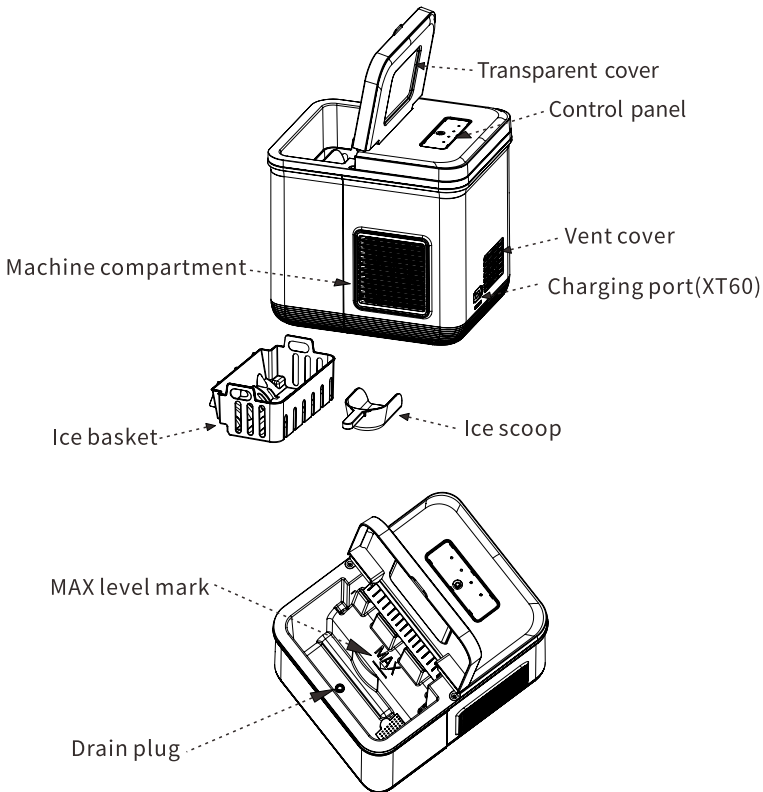

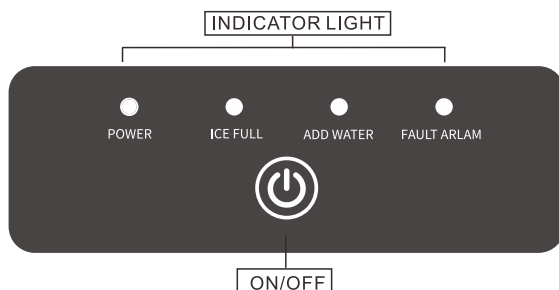

4.FUNCTION AND OPERATION



■ Before First Use:

- After unpacking the ice maker, the "Parts and Features" section should be checked to ensure all components are included.
- Before starting the device for the first time, clean interior of the ice maker using clean cloth or sponge with warm, soapy water.
- Place the ice maker on a dry, flat surface in a location that is protected from sunlight.
- Allow two hours for the refrigerant fluid to settle before plugging the cord into an electrical outlet for the first time.

■ How to Make Ice:

- ① Open the transparent cover to remove the ice basket and pour water into the water tank. Keep the water level below the MAX level mark. If water levels exceed the MAX level mark, drain any excess water by removing the water drain plug;
- ② The ice maker should be connected to a DC 12V/24V or AC 100~240V, 50/60Hz power supply (using dedicated adapter). The buzzer will make a long beep, all indicator lights will be on for 1 second, and the standby mode will be entered, with the power indicator light pulsing slowly.
- ③ The ice maker is switched on by short pressing the  button, and working mode is entered, the power indicator will be solid green. The ice maker is switched off by short pressing the  button again, and standby mode is entered, with the power indicator light pulsing slowly.
- ④ When the ice basket is full, the ICE FULL indicate will flush blue, and the ice making cycle will be stopped. The ice maker will automatically begin to making ice after the ice is removed.
- ⑤ When the water tank is lack of water, the ADD WATER indicate will be solid red, and the ice making cycle will be stopped. Fill water up to the MAX level mark and press the ON/OFF button to turn on the ice maker.

5.CLEANING AND MAINTENANCE

■Cleaning:

- Unplug the device first to avoid electric shock.
- Take out the ice basket and ice scoop, and wash them in warm and soapy water.
- Use a soft wet towel to clean the interior and exterior of the device.
- Do not soak the device in water and do not wash it directly.
- Drain the interior water by unplugging the water drain plug on the bottom of the device.
- Dry the interior and exterior with a soft, non-abrasive cloth.

■Storage:

If the device will not be in use for a long time, please follow the instruction:

- Turn off the power and remove the plug.
- Completely drain the water from the water tank.
- Keep the water drain open.
- Put the device in a cool and dry place.

6.TROUBLESHOOTING

Issues	Suggestions
The device does not work	Check if the switch is on.
	Check if the plug and socket are not connected well.
	Check if the fuse has been burnt.
	Check if the power supply is malfunctional.
	Switching on/off the ice maker frequently may cause start delay of the compressor.
The ice cubes stick together	Ice cubes are oversized. Increase the water temperature or place the ice maker in a warmer environment.
The ice cubes have odor /taste	Ice stored for an extended period may absorb odors. Discard old cubes, use the device regularly.
	The interior of the device needs cleaning.
Fault alarm indicate flashes once every 3 seconds	Possible cause: low voltage to ice maker. Make sure to connect to correct voltage.
Fault alarm indicate flashes twice every 3 seconds	Possible cause: condenser fan is overloaded. Contact manufacturer for service.
Fault alarm indicate flashes three every 3 seconds	Possible cause: compressor not kick in. Contact manufacturer for service.
Fault alarm indicate flashes four every 3 seconds	Possible cause: compressor is overloaded. Contact manufacturer for service.
Fault alarm indicate flashes five times every 3 seconds	Possible cause: overheating of the compressor & electronics. Contact manufacturer for service.
Fault alarm indicate flashes six times every 3 seconds	Possible cause: no parameter can be detected by the controller. Contact manufacturer for service.
Fault alarm indicate flashes seven times every 3 seconds	Possible cause: temperature sensor circuit is short. Contact manufacturer for service.
Fault alarm indicate flashes eight times every 5 seconds	Possible cause: The flip motor limit switch is not in position. check for ice or debris that may be preventing the water tray from returning to its correct position.

7.WARRANTY

If the device gets malfunctional, limited warranty will be provided for 1 year from the date of purchase, except following situations:

- Contrived damage.
- Damage caused by force majeure such as earthquake, conflagration, etc.
- Damage from inappropriate use or violating this instruction.
- Damage or malfunction caused by disassembling.

8.TECHNICAL INFORMATION

Model	CZB-15
Rated Voltage	DC12/24V or AC100~240V, 50/60Hz(using the adapter)
Rated Power Input	90W
Sound Noise Level	≤45dB
Climate Class	ST/N/SN
Product Dimension(L*W*H)	293*229*279mm (11 9/16*9 1/16*12 inch)
Packing Dimension(L*W*H)	345*285*342mm (13 5/8*11 1/4*13 1/2 inch)
Loading QTY (20/40/40HQ)	768/1596/1862
Net Weight	5.1kg/11lb
Gross Weight	6.4kg/14lb
Rated Current	AC 1.7A-0.7A DC 7.2A/3.6A
Cooling Method	Direct Refrigeration
Ice Making cycle	8.5 minutes/cycle
Daily Capacity	24lb/24h
Ice Basket Capacity	0.8kg/1.76lb ice cubes per basket
Water Tank Capacity	1.3L/0.05Cu.Ft.

* All technical data is based on 25°C/77°F ambient and initial water temperature.

* Due to product improvement, the technical information might be different from actual information, please refer to the rating label on the product.